

# OPEL

AGILA (A) (H00)				-7,2015	
OEM	Info			Info	OEM
47 01 745	Length: 219 mm Outer Thread: M12x1,25 mm Thread Size: M14x1,5	OP02-003	OP02-003	Length: 219 mm Outer Thread: M12x1,25 mm Thread Size: M14x1,5	47 01 745
47 05 716	Inner Thread: M12x1,25 mm	OP01-001	OP01-001	Inner Thread: M12x1,25 mm	47 05 716
47 05 742		OP06-004	OP06-004		47 05 742
47 05 172		OP06-002	OP06-002		47 05 172



ANTARA				-6,2015	
OEM	I			In	OEM
48 02 966		CH04-003	CH04-004		48 02 967
48 03 429	Suspended Thread Size: M12x1,5 Outer Thread: M14x1,5	CH01-001	CH01-001	Suspended Thread Size: M12x1,5 Outer Thread: M14x1,5	48 03 429
48 06 300	Height: 72 mm Thread Size: M12x1,75	CH03-002	CH03-002	Height: 72 mm Thread Size: M12x1,75	48 06 300
48 04 642		CH04-005	CH04-005		48 04 642



ASCONA C (81_, 84_, 86_, 87_, 88_, 89_)				09.1981 - 10.1988	
OEM	In			Info	OEM
1603121		OP03-007	OP03-007		163121
3 24 039	with right-hand thread Inner Thread: M16x1,5	OP01-005	OP01-006	with left-hand thread Inner Thread: M16x1,5mm	3 24 038
3 52 323	Outer Diameter: 35,5mm	OP05-009	OP05-008	Outer Diameter: 35,5mm	3 52 323



OP01-005



OP01-006



OP03-007



OP03-007



OP05-009



OP05-008

ASTRA(F)				1991-1998	
OEM	I			In	OEM
3 50 260	Suspension Rod with	OP04-013	OP04-013	Suspension Rod with	3 50 260
3 50 263	Suspension Rod with	OP04-014	OP04-014	Suspension Rod with	3 50 263
3 50 261	Suspension Rod	OP04-012	OP04-012	Suspension Rod	3 50 261
3 24 053	with accessories with right-hand thread Outer Thread: M12x1,5 mm Inner Thread:	OP01-011	OP01-010	with accessories with left-hand thread Outer Thread: M12x1,5 mm Inner Thread: M16x2	3 24 054
3 52 077	Control Arm with ball joint, with rubber mounting Sheet Steel	OP05-016	OP05-015	Control Arm with ball joint, with rubber mounting Sheet Steel	3 52 076
1603121		OP03-007	OP03-007		1603121

OP04-013



OP04-013



OP04-014



OP04-014



# OPEL

OP04-012



OP04-012



OP01-011



OP01-010



OP05-016



OP05-015



OP03-007



OP03-007



ASTRA(G) ZAFIRA(F75)				1998-2004	
OEM	I			In	OEM
16 03 213	for steering gear manufacturer: DELPHI	OP02-018	OP02-018	for steering gear manufacturer: DELPHI	16 03 213
3 50 611	Suspension Rod with	OP04-020	OP04-020	Suspension Rod with	3 50 611
16 03 214	with accessories	OP01-017	OP01-017	with accessories	16 03 214
53 52 005	Control Arm with ball joint, with rubber mounting Sheet Steel	OP05-021	OP05-021	Control Arm with ball joint, with rubber mounting Sheet Steel	3 52 030
352800	D=Ø18MM	OP03-019	OP03-019	D=Ø18MM	352800

OP02-018



OP02-018



OP04-020



OP04-020



OP01-017



OP01-017



OP05-021



OP05-022



OP03-019



OP03-19



<b>ASTRA (H) -4,2015</b>					
<b>OEM</b>	<b>Info</b>			<b>Info</b>	<b>OEM</b>
16 03 264	for steering manufacturer:ZF Thread Size: M16x1,5 for vehicles with standard chassis	<b>OP02-025</b>	<b>OP02-025</b>	for steering manufacturer:ZF Thread Size: M16x1,5 for vehicles with standard chassis	16 03 264
16 03 256	for steering gear ID:TRW for vehicles with standard chassis Length: 265 mm Outer Thread: M14x1,5 mm Thread Size: M18x1,5	<b>OP02-018</b>	<b>OP02-018</b>	for steering gear ID:TRW for vehicles with standard chassis Length: 265 mm Outer Thread: M14x1,5 mm Thread Size: M18x1,5	16 03 256
3 50 611	Suspension Rod withaccessories	<b>OP04-020</b>	<b>OP04-020</b>	Suspension Rod withaccessories	3 50 611
3 50 613		<b>OP04-026</b>	<b>OP04-026</b>		3 50 613
16 03 266	withaccessories	<b>OP01-024</b>	<b>OP01-023</b>	withaccessories	16 03 267
53 52 029		<b>OP05-028</b>	<b>OP05-027</b>		53 52 030
352800	D=Ø18MM	<b>OP03-019</b>	<b>OP03-019</b>	D=Ø18MM	352800



# OPEL

ASTRA J				-9,2015	
OEM	I			In	OEM
3 50 618	Suspension Rod Thread Size: M12x1,75 Length: 304 mm Diameter	OP04-032	OP04-032	Suspension Rod Thread Size: M12x1,75 Length: 304 mm Diameter	3 50 618
3 50 617	Suspension Rod Thread Size: M12x1,75 Length: 304 mm Plastic	OP04-033	OP04-033	Suspension Rod Thread Size: M12x1,75 Length: 304 mm Plastic	3 50 617
16 09 026	Suspended Thread Measurement 1: M12x1,75 Thread Size 2: M16x1,5 Length: 119 mm	OP01-029	OP01-029	Suspended Thread Measurement 1: M12x1,75 Thread Size 2: M16x1,5 Length: 119 mm	16 09 026
3 52 106	Control Arm	OP05-035	OP05-034	Control Arm	3 52 115
13286687	M16x1,5 – 291MM	OP02-030	OP02-030	M16x1,5 – 291MM	13286687
13314645	M16x1,5 – 288MM	OP02-031	OP02-031	M16x1,5 – 288MM	13314645

OP04-032



OP04-032

OP04-033



OP04-033

OP01-029



OP01-029

OP02-030



OP02-030

OP02-031



OP02-031

OP05-035



OP05-034

CHEVETTE				1975-	
OEM	I			In	OEM
90004080-1	M14x1,5MM R	OP01-036	OP01-036	M14x1,5MM R	90004080-1
089884058	M14x1,5-L=222mm	OP02-0037	OP02-037	M14x1,5-L=222mm	089884058
310816		OP03-038	OP03-038		310816
7329482		OP03-039	OP03-039		7329482



OP01-036

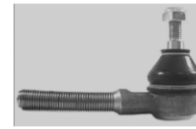

OP01-036



OP02-037



OP02-037



OP03-038



OP03-038



OP03-039



OP03-039

CORSA A				02.1986 - 09.1994	
OEM	I			In	OEM
16 03 4536	with accessories with right-hand thread Outer Thread: M12x1,5 mm Inner Thread:	OP02-041	OP02-041	with accessories with right-hand thread Outer Thread: M12x1,5 mm Inner Thread:	16 03 4536
16 03 009	Inner Thread: M12x1,5 mm Length: 70 mm	OP10-040	OP10-040	Inner Thread: M12x1,5 mm Length: 70 mm	16 03 009
16 03 128	with fastening material	OP03-042	OP03-042	with fastening material	16 03 128
352003		OP05-044	OP05-043		352002

OP02-041



OP02-041

OP01-040



OP01-040

OP03-042



OP03-042

OP05-044



OP05-043

# OPEL

CORSA A COMBO-TIGRA				02.1986 - 09.1994	
OEM	I			In	OEM
16 03 4536	with accessories with right-hand thread Outer Thread: M12x1,5 mm Inner Thread:	OP02-041	OP02-041	with accessories with right-hand thread Outer Thread: M12x1,5 mm Inner Thread:	16 03 4536
16 03 009	Inner Thread: M12x1,5 mm Length: 70 mm	OP10-040	OP10-040	Inner Thread: M12x1,5 mm Length: 70 mm	16 03 009
16 03 128	with fastening material	OP03-042	OP03-042	with fastening material	16 03 128
352003		OP05-046	OP05-045		352002

OP02-041



OP02-041

OP01-040



OP01-040

OP03-042



OP03-042

OP05-046



OP05-045

CORSA B				03.1993 - 02.2015	
OEM	I			In	OEM
16 03 4536	with accessories with right-hand thread Outer Thread: M12x1,5 mm Inner Thread:	OP02-049	OP02-049	with accessories with right-hand thread Outer Thread: M12x1,5 mm Inner Thread:	16 03 4536
3 22 158	with right-hand thread	OP02-048	OP02-048	with right-hand thread	3 22 158
16 03 455	with accessories with right-hand thread Inner Thread: M12x1,5	OP01-047	OP01-047	with accessories with right-hand thread Inner Thread: M12x1,5	16 03 455
16 03 202		OP03-050	OP03-050		16 03 202
53 52 011	Control Arm without ball joint, with rubber mounting Sheet Steel	OP05-053	OP05-052	Control Arm without ball joint, with rubber mounting Sheet Steel	53 52 011
350610	L=243mm	OP04-051	OP04-051	L=243mm	35610

OP02-049



OP02-049

OP02-048



OP02-048

OP01-047



OP01-047



CORSA C				-9,2	
OEM	I			I	OEM
16 03 008	Thread Size: M14x1,5 Outer Thread: M12x1,5 mm Length: 285 mm	OP02-054	OP02-054	Thread Size: M14x1,5 Outer Thread: M12x1,5 mm Length: 285 mm	16 03 008
3 50 610	Suspension Rod with	OP04-051	OP04-051	Suspension Rod with	3 50 610
16 03 009	Inner Thread: M12x1,5 mm Length: 70 mm	OP01-040	OP01-040	Inner Thread: M12x1,5 mm Length: 70 mm	16 03 009
3 52 803		OP03-055	OP03-055		3 52 803
3 52 041	with rubber mounting, with fastening material Control Arm	OP05-057	OP05-056	with rubber mounting, with fastening material Control Arm	3 52 042





# OPEL

CORSA D				-6,2015	
OEM	I			In	OEM
16 03 543	Length: 269 mm Outer Thread: M14x1,5 mm Thread Size:	OP02-058	OP02-058	Length: 269 mm Outer Thread: M14x1,5 mm Thread Size: M14x1,5	16 03 543
3 50 175		FT04-004	FT04-004		3 50 175
16 03 544	Suspended Thread Size: M10x1,5 Thread Measurement 1: M14x1,5	FT01-002	FT01-001	Suspended Thread Size: M10x1,5 Thread Measurement 1: M14x1,5	16 03 545
3 52 067		FT03-003	FT03-003		3 52 067
53 52 039	Control Arm	OP05-060	OP05-059	Control Arm	53 52 038

OP02-058



OP02-058

FT04-004



FT04-004

FT01-002



FT01-001

FT03-003



FT03-003

OP05-060



OP05-059

CORSA UTILITY (south Africa)				2003-	
OEM	I			I	OEM
		OP01-061	OP01-061		
	M14x1,5 L=275	CH02-006	CH02-006	M14x1,5 L=275	
350610	L=243	OP04-051	OP04-051	L=243	350610
0352063	D=16mm	OP05-057	OP05-056	D=16mm	0352061
3 52 803		OP03-055	OP03-055		3 52 803



OP01-061



OP01-061



CH02-006



CH02-006



OP04-051



OP04-051



OP03-055



OP03-055



OP05-057



OP05-056

INSIGNIA				07,2008-	
OEM	I			I	OEM
350617	Suspension Rod L=304	OP04-032	OP04-032	Suspension Rod L=304	350617
32272000	M16x1,5	OP01-029	OP01-029	M16x1,5	32272000
13271996	M16x1,5 L=309mm	OP02-062	OP02-062	M16x1,5 L=309mm	13271996
350618	L=304	OP04-033	OP04-033	L=304	350618
444081	L=71,5	OP04-063	OP04-063	L=71,5	444081
444087	L=133mm	OP04-064	OP04-064	L=133mm	444087
352050		OP05-066	OP05-065		352071



OP04-032



OP04-032



OP01-029



OP01-029

# OPEL

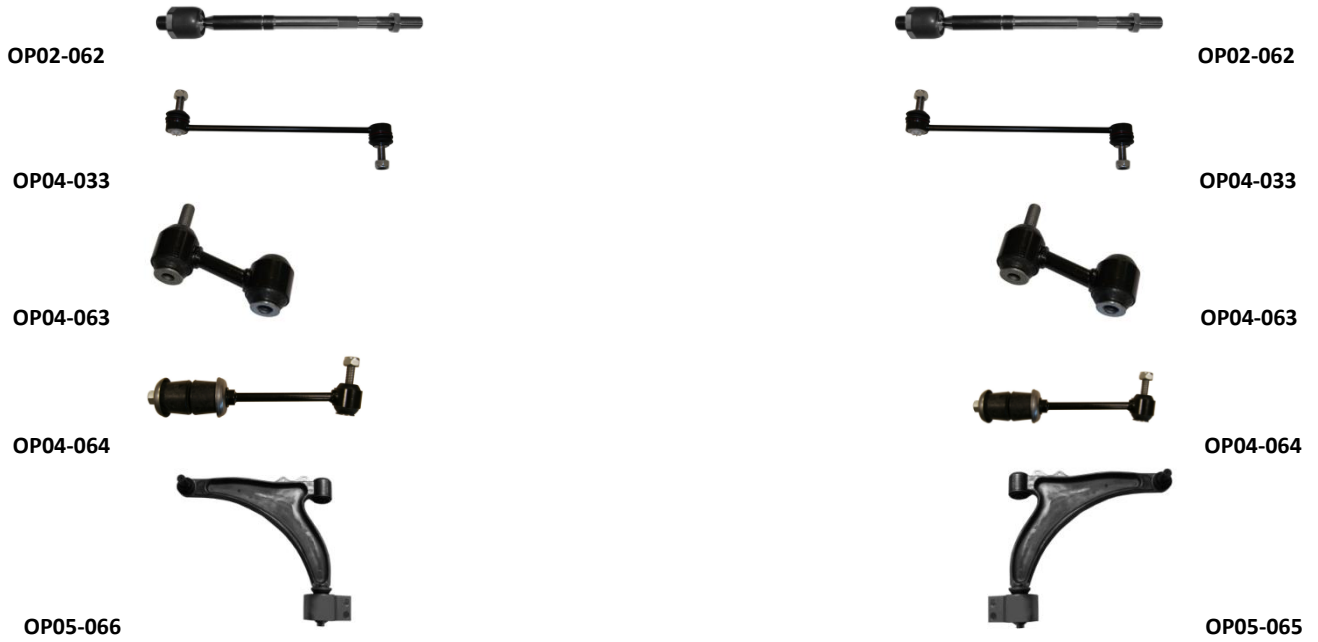

FRONTERA A (5_MWL4,5_SUD2)				03.1992 -	
OEM	I			I	OEM
3 50 607	Suspension Rod	OP04-067	OP04-068	Suspension Rod	3 50 608
3 24 057	with right-hand thread	I01-001	I01-001	with right-hand thread	3 24 057
3 24 058	with left-hand thread	I01-002	I01-002	with left-hand thread	3 24 058
3 52 828		I03-003	I03-003		3 52 828
3 10 821		I03-004	I03-004		3 10 821

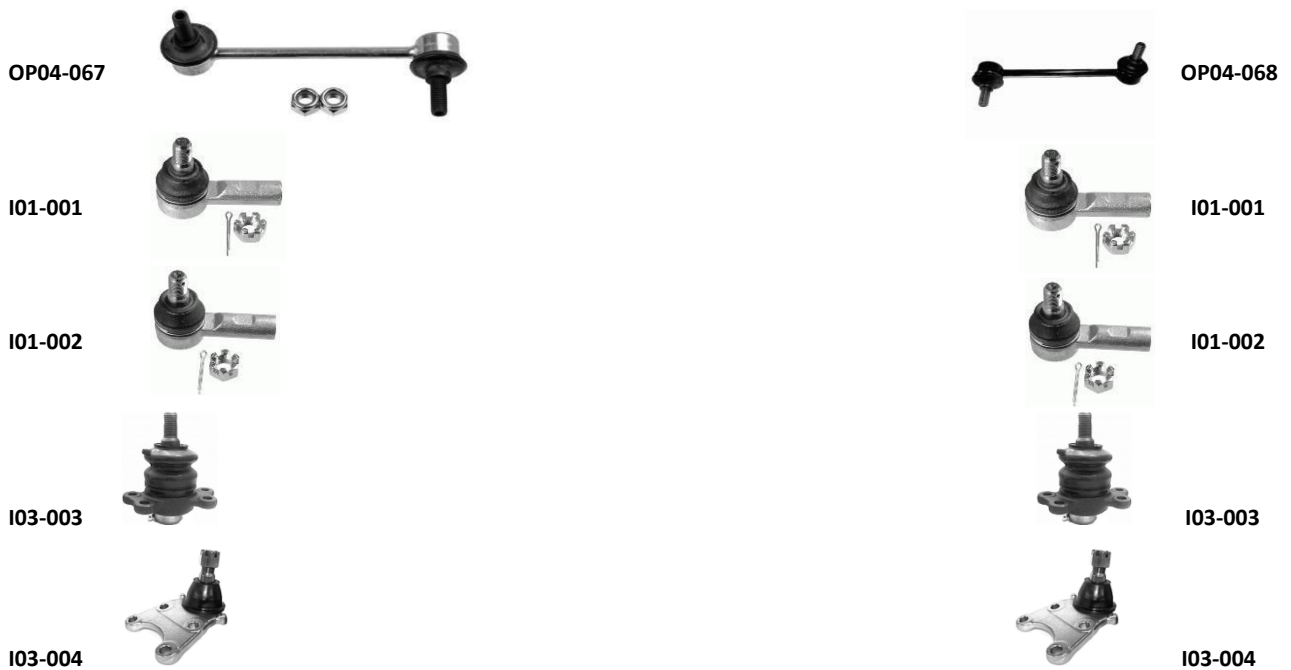

FRONTERA B (6B_) -10,1998					
OEM	I			I	OEM
894459463		I03-005	I03-005		894459463
3 50 607	Suspension Rod	OP04-067	OP04-068	Suspension Rod	3 50 608
3 52 828	D=17,5mm	I03-003	I03-003	D=17,5mm	3 52 828
3 10 823		OP03-070	OP03-070		3 10 823
900907	M14x1,5	OP01-069	OP01-069	M14x1,5	900907

I03-005



I03-005



OP04-068



OP04-068



I03-003



I03-003



OP03-070



OP03-070



OP01-069



OP01-069



KADDET (B) 1968-1973					
OEM	I			I	OEM
352814		OP03-071	OP03-071		352814

OP03-071



OP03-071



KADDET (C) 1968-1973					
OEM	I			I	OEM
352817	D=14mm	OP03-072	OP03-072	D=14mm	352817

OP03-072



OP03-072



KADDET (D)				1968-1973	
OEM	I			I	OEM
324036	M16x1,5	OP01-074	OP01-073	M16x1,5	324037
1603115		OP03-075	OP03-075		1603115

OP01-074



OP01-073



OP03-075



OP03-075



KADDET (F)				1968-1973	
OEM	I			I	OEM
26001807	M16x1,5 Lh	OP01-005	OP01-006	M16x1,5Rh	26001806
1603120		OP03-076	OP03-076		1603120
352124		OP05-078	OP05-077		352162

OP01-005



OP01-006



OP03-076



OP03-076



OP05-077



OP05-078



MERIVA A				05.2003 -	
OEM	I			I	OEM
16 03 016		OP02-080	OP02-080		16 03 016
3 50 610	Suspension Rod with	OP04-051	OP04-051	Suspension Rod with	3 50 610
16 03 240	Thread Size: M10x1,5 Thread Size 2: M14x1,5	OP01-079	OP01-079	Thread Size: M10x1,5 Thread Size 2: M14x1,5	16 03 240
5352025		OP03-081	OP03-081		5352025
5352027		OP05-083	OP05-082		53 52 028

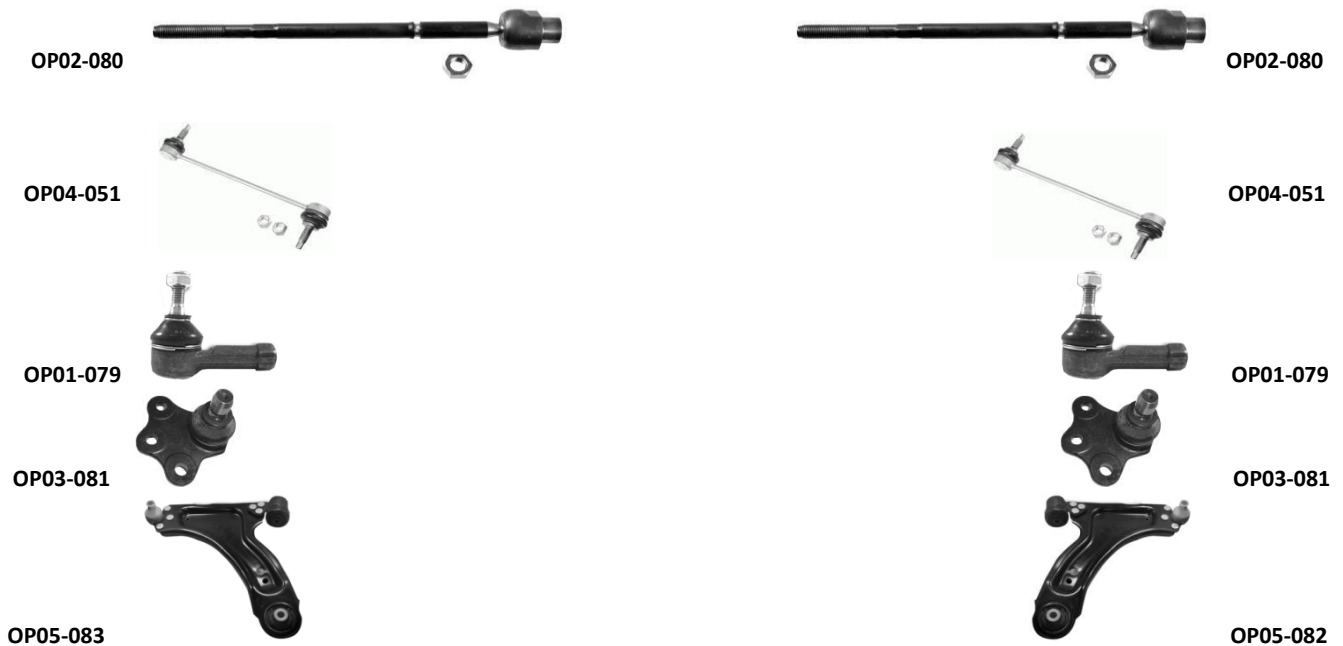

MERIVA B				-10,2015	
OEM	I			I	OEM
16 09 013	Suspended Thread Size: M12x1,5 Thread Measurement 1: M14x1,5 Length: 139 mm	OP01-024	OP01-024	Suspended Thread Size: M12x1,5 Thread Measurement 1: M14x1,5 Cone Pitch: 1:6	16 09 012
53 52 029		OP05-028	OP05-027		53 52 030
1609011	M14x1,5 L=233mm	OP02-083	OP02-083	M14x1,5 L=233mm	1609011
	M14x1,5 L=233mm	OP02-082	OP02-082	M14x1,5 L=233mm	
350610	L=243mm	OP04-051	OP04-051	L=243mm	350610
352800		OP03-019	OP03-019		352800



# OPEL



OP02-083



OP02-083



OP02-082



OP02-082



OP04-051



OP04-051



OP03-019



OP03-019

MOVANO (A)				-1,1998	
OEM	I			I	OEM
44 18 780	Length: 150 mm Thread Size: M14x1,5, M16x1,5 with accessories	RN02-003	RN02-003	Length: 150 mm Thread Size: M14x1,5, M16x1,5 with accessories	44 18 780
44 18 192	Suspension Rod with	RN04-006	RN04-005	Suspension Rod with	44 18 193
45 01 262		RN01-002	RN01-001		45 01 263
45 00 254	with accessories	RN03-004	RN03-004	with accessories	45 00 254
44 01 909	with accessories	RN03-008	RN03-008	with accessories	44 01 909
44 01 910		RN03-007	RN03-007		44 01 910
44 18 631	with accessories	RN03-009	RN03-009	with accessories	44 18 631
44 01 852		RN05-011	RN05-010		44 01 853
4404047		RN05-013	RN05-012		4400048



RN02-003



RN02-003



RN04-006



RN04-005



RN1-002



RN1-001



RN03-004



RN03-004

# OPEL

RN03-008



RN03-008

RN03-007



RN03-007

RN3-009



RN03-009

RN05-011



RN05-010

RN05-013



RN05-012

MOVANO B						-10,2015
OEM						OEM
44 19 291	Length: 330 mm Thread Size: M10x1,5	RN04-018	RN04-018	Length: 330 mm Thread Size: M10x1,5		44 19 291
44 20 097	Vertical Thread Size: M14x1,5 Inner Thread: M18x1,5	RN01-015	RN01-014	Vertical Thread Size: M14x1,5 Inner Thread: M18x1,5		44 20 098
44 19 219	Cone Size: 23 mm Thread Size:	RN03-017	RN03-017	Cone Size: 23 mm Thread Size:		44 19 219
48521-2373R	M18x1,5 L=253mm	RN02-016	RN02-016	M18x1,5 L=253mm		48521-2373R
55110-0019R		RN04-019	RN04-019			55110-0019R
8200688871		RN05-021	RN05-020			8200688875

RN04-018



RN04-018

RN01-015



RN01-014

RN03-017



RN03-017

RN02-016



RN02-016



# OPEL



RN04-019

RN05-021



RN04-019

RN05-020

OMEGA A SENATOR (B)				09.1986 - 05.1994	
OEM	Info			Info	OEM
0322171	M14x1,5Lht	OP01-085	OP01-084	M14x1,5Rht	0322172
0322175	M14x1,5 Lht	OP01-087	OP01-086	M14x1,5Rht	0322176
322002		OP01-089	OP01-088		322003
322140	572mm	OP01-090	OP01-090	572mm	322140
0352826	D=18mm	OP03-092	OP01-091	D=18mm	0352827
350604	L=230mm	OP04-093	OP04-093	L=230mm	350604
	L=230mm	OP04-093P	OP04-093P	L=230mm	
352132		OP05-095	OP05-094		352134



OP01-085

OP01-087

OP01-089

OP01-090

OP03-092

OP04-093

OP04-093P

OP05-095



OP01-084

OP01-086

OP01-088

OP01-090

OP03-091

OP04-093

OP04-093P

OP05-094

OMEGA B (21_ , 22_ , 23_ , 25_ , 26_ , 27_ )				03.1994 -	
OEM	I			I	OEM
0322171	M14x1,5Lht	OP01-085	OP01-084	M14x1,5Rht	0322172
0322175	M14x1,5Lht	OP01-087	OP01-086	M14x1,5Rht	0322176
322002	OP01-085/OP01-087	OP01-089	OP01-088	OP01-084/OP01-086	322003
0322169		OP01-101	OP01-101		0322168
350600	L=224,5	OP04-103	OP04-103	L=224,5	350600
322178	M14x1,5 Lht	OP01-097	OP01-096	M14x1,5 Rht	3 22 177
3 22 179	M14x1,5 Lht	OP01-099	OP01-098	M14x1,5 Rht	3 22 180
352197	OP03-019	OP05-105	OP05-104	OP03-019	352196
3 22 136		OP01-102	OP01-102		3 22 136
352800	D=18mm	OP03-019	OP03-019	D=18mm	352800

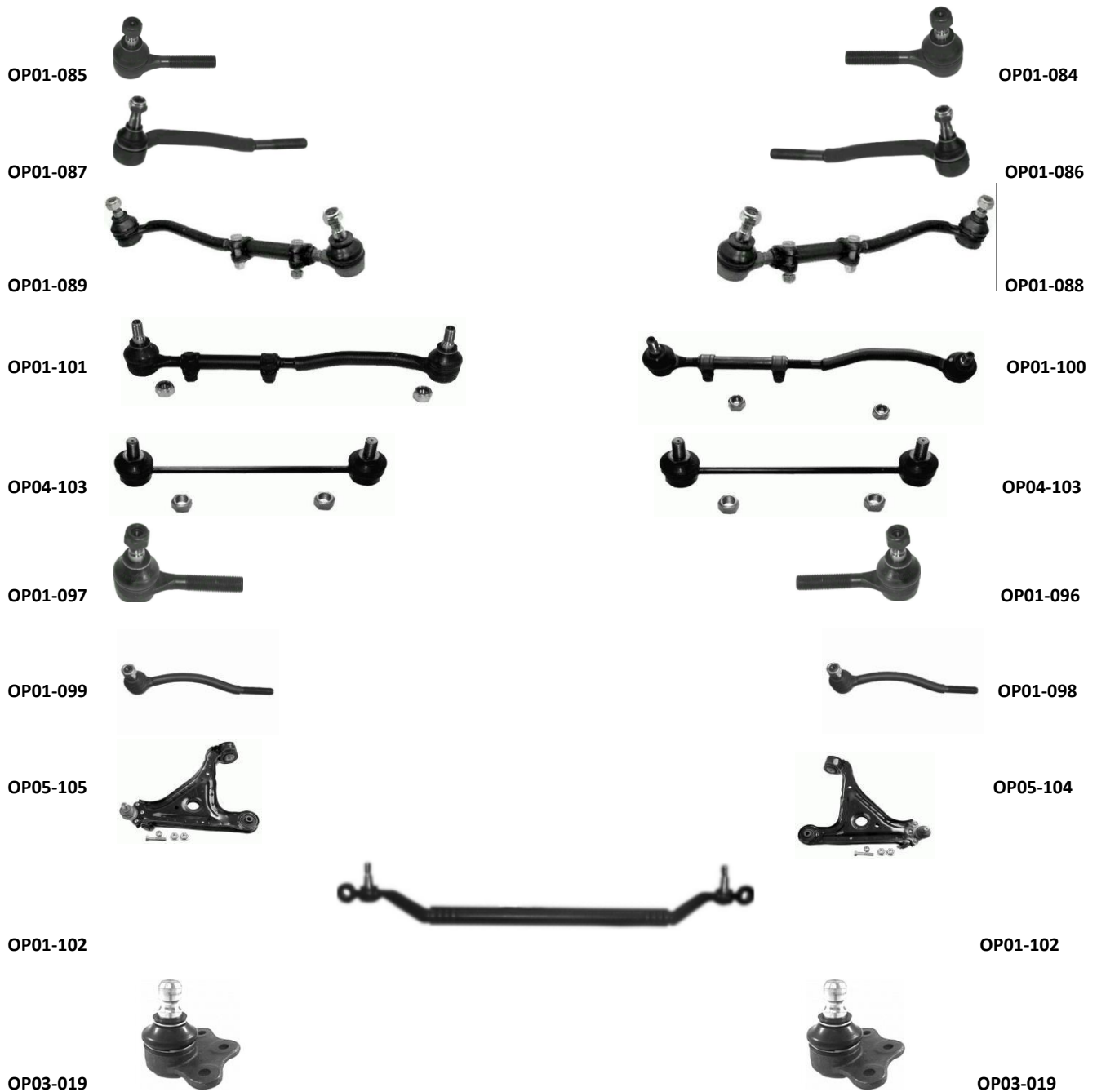

# OPEL

RECORD(C)					1966-71
OEM	Info			Info	OEM
352811		OP03-106	OP03-106		352811



OP03-106



OP03-106

RECORD(D) COMMODORE(D)					1972-77
OEM	Info			Info	OEM
324113	M14x1,5Lht	OP01-108	OP01-107	M14x1,5Rht	324112
310811		OP03-109	OP03-109		310811
352820	D=17mm	OP03-110	OP03-110	D=17mm	352820



OP01-108



OP01-102



OP03-109



OP03-109



OP03-110



OP03-110

RECORD(E) COMMODORE(C)					1977-86
OEM	Info			Info	OEM
324045	M14x1,5Lht	OP01-111	OP01-111	M14x1,5Rht	324045
324044	M14x1,5Lht	OP03-112	OP03-112	M14x1,5Rht	324044
352821		OP03-113	OP03-113		352821
350602	L=195mm	OP03-114	OP03-114	L=195mm	350602



OP01-111



OP01-111



OP01-112



OP01-112



OP03-113



OP03-113



OP04-114



OP04-114

SIGNUM				-3,2015	
OEM	I			I	OEM
16 03 229	Thread Measurement 1: M18x1,5 Thread Size 2: M14x1,5 Length: 284 mm	OP02-117	OP02-117	Thread Measurement 1: M18x1,5 Thread Size 2: M14x1,5 Length: 284 mm	16 03 229
3 50 603	L=352,5mm	OP04-118	OP04-118	L=352,5mm	3 50 603
03 50 603	L=352,5mm	OP04-118P	OP04-118P	L=352,5mm	03 50 603
16 03 227	Thread Size: M12x1,5 Inner Thread: M14x1,5 mm with accessories	OP01-116	OP01-115	Thread Size: M12x1,5 Inner Thread: M14x1,5mm with	16 03 228
3 52 051	Control Arm Aluminium	OP05-119	OP05-120	Control Arm Aluminium	3 52 052

OP02-117



OP02-117

OP04-118



OP04-118

OP04-118P



OP04-118P

OP01-116



OP01-116

OP05-120



OP05-120

# OPEL

VECTRA(A) CALIBRA				1988-95	
OEM	I			In	OEM
3 50 260	Suspension Rod with	OP04-013	OP04-013	Suspension Rod with	3 50 260
3 50 263	Suspension Rod with	OP04-014	OP04-014	Suspension Rod with	3 50 263
3 50 261	Suspension Rod	OP04-012	OP04-012	Suspension Rod	3 50 261
3 24 053	with accessories with right-hand thread Outer Thread: M12x1,5 mm Inner Thread:	OP01-011	OP01-010	with accessories with left-hand thread Outer Thread: M12x1,5 mm Inner Thread: M16x2	3 24 054
3 52 077	Control Arm with ball joint, with rubber mounting Sheet Steel	OP05-016	OP05-015	Control Arm with ball joint, with rubber mounting Sheet Steel	3 52 076
1603121		OP03-007	OP03-007		1603121

OP04-013



OP04-013

OP04-014



OP04-014

OP04-012



OP04-012

OP01-011



OP01-010

OP05-016



OP05-015

OP03-007



OP03-007

VECTRA B (36, 31, 38)				09.1995 -	
OEM	I			I	OEM
16 03 198	with right-hand thread for steering manufacturer:ZF Thread Size:M16x1,5	OP02-122	OP02-122	with right-hand thread for steering manufacturer:ZF Thread Size:M16x1,5	16 03 198
16 03 199	for OE No.:SAGINAW Thread Size:M14x1,5	OP02-123	OP02-123	for OE No.:SAGINAW Thread Size:M14x1,5	16 03 199
3 50 610	Suspension Rod with accessories	OP04-051	OP04-051	Suspension Rod with accessories	3 50 610
3 50 610*	Suspension Rod with accessories	OP04-051P	OP04-051P	Suspension Rod with accessories	3 50 610*
16 03 286	with right-hand thread Outer Thread: M14x1,5 mm	OP01-121	OP01-121	with right-hand thread Outer Thread: M14x1,5 mm	16 03 286
53 52 005	Control Arm with ball joint, with rubber mounting Sheet Steel	OP05-022	OP05-021	Control Arm with ball joint, with rubber mounting Sheet Steel	3 52 030
352800	D=Ø18MM	OP03-019	OP03-019	D=Ø18MM	352800



# OPEL

VECTRA C				-2,2015	
OEM	I			I	OEM
16 03 229	Thread Measurement 1: M18x1,5, M14x1,5 Length: 303 mm	OP02-126	OP02-126	Thread Measurement 1: M18x1,5, M14x1,5 Length: 303 mm	16 03 229
16 03 244	Thread Measurement 1: M18x1,5 Thread Size 2: M14x1,5 Length: 260 mm	OP02-127	OP02-127	Thread Measurement 1: M18x1,5 Thread Size 2: M14x1,5 Length: 260 mm	16 03 244
3 50 603		OP04-128	OP04-128		3 50 603
		OP04-129	OP04-129		
		OP04-129P	OP04-129P		
16 03 227	Thread Size: M12x1,5 Inner Thread: M14x1,5 mm with accessories	OP01-125	OP01-124	Thread Size: M12x1,5 Inner Thread: M14x1,5 mm with accessories	16 03 228
3 52 051	Control Arm	OP05-131	OP05-130	Control Arm	3 52 052

OP02-126



OP02-126

OP02-127



OP02-127

OP04-128



OP04-128

OP04-129



OP04-129

OP04-129P



OP04-129P

OP01-125



OP01-124

OP05-131



OP05-130

# OPEL

VIVARO (F7, J7, E7)					-1,2015
OEM	I			I	OEM
44 08 474	Thread Measurement 1: M12x1,0 Thread Size 2: M14x1,5 Length: 245 mm	RN02-024	RN02-024	Thread Measurement 1: M12x1,0 Thread Size 2: M14x1,5 Length: 245 mm	44 08 474
44 08 904	Length: 280 mm Thread Size: M10x1,5 Suspension Rod with accessories	RN04-026	RN04-026	Length: 280 mm Thread Size: M10x1,5 Suspension Rod with accessories	44 08 904
44 08 904	Length: 280 mm Thread Size: M10x1,5 Suspension Rod with accessories	RN04-026P	RN04-026P	Length: 280 mm Thread Size: M10x1,5 Suspension Rod with accessories	44 08 904
44 08 510		RN01-023	RN01-022		44 08 511
44 19 075	Cone Size: 19,55 mm Bore Ø: 10 mm	RN03-025	RN03-025	Cone Size: 19,55 mm Bore Ø: 10 mm	44 19 075
44 08 958	Sheet Steel	RN05-028	RN05-028	Sheet Steel	44 08 959

RN02-024



RN02-024

RN04-026



RN04-026

RN04-026P



RN04-026P

RN01-023



RN01-023

RN03-025



RN03-025

RN05-028



RN05-027



ZAFIRA (B)				-7,2015	
OEM	Info			Info	OEM
16 03 264	for steering manufacturer:ZF Thread Size: M16x1,5 for vehicles with standard chassis	OP02-025	OP02-025	for steering manufacturer:ZF Thread Size: M16x1,5 for vehicles with standard chassis	16 03 264
16 03 287	for steering gear ID:TRW for vehicles with standard chassis Length: 262 mm Outer Thread: M14x1,5 mm Thread Size: M18x1,5	OP02-132	OP02-132	for steering gear ID:TRW for vehicles with standard chassis Length: 262 mm Outer Thread: M14x1,5 mm Thread Size: M18x1,5	16 03 287
3 50 611	Suspension Rod with accessories	OP04-020	OP04-020	Suspension Rod with accessories	3 50 611
16 03 266	with accessories	OP01-024	OP01-023	with accessories	16 03 267
53 52 029		OP05-028	OP05-027		53 52 030
352800	D=Ø18MM	OP03-019	OP03-019	D=Ø18MM	352800

